

## User Manual

### MS657031X Industrial GBE PoE / PoE+ Injector up to 30W, IEEE802.3af/at



#### CE MARKING

This equipment complies with the requirements relating to electromagnetic compatibility, EN 55022 class A for ITE, the essential protection requirement of Council Directive 2004/108/EC on the approximation of the laws of the Member States relating to electromagnetic compatibility.

# MICROSENS

## NOTE:

Always make sure the total length of the TX cable DOES NOT exceed 100 meter. Total length is defined as length A + length B.

Length A + Length B < 100 meter



Maximum total cable length is 100 meter.

During 1000 Mbps speed transmission; recommend maximum cable length less than 90 meter is recommended.

POE signal attenuates every meter, the built-in transformer allows the attenuation to reach 100 meter long to follow IEEE802.3af / at standard. The higher quality of PD you connected to, the more reliable the network will be. When connect to a poor quality PD, it cannot generate strong signal to send to remote switch. Always make sure you have a high quality PD to perform a desired network.

## Installation package

This unit can be installed by din-rail mounted or wall-mounted. Din-rail brackets and wall-mounted bracket are included at delivery.

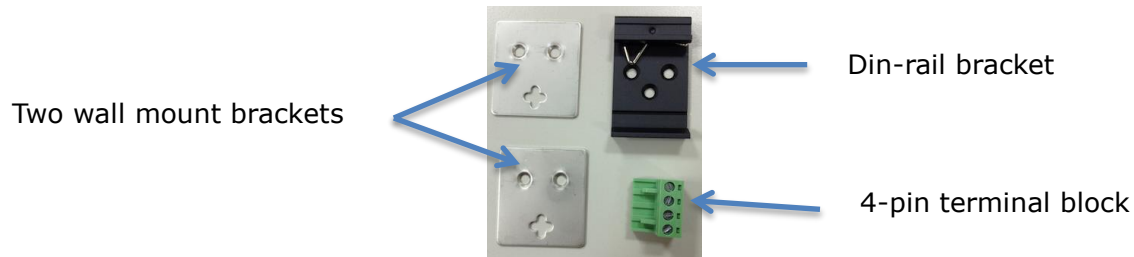

## Power connection

This unit is equipped with POE capability to deliver 30 W POE power. The provided 4-pin terminal block can be connected with 44 VDC to 56 VDC power source. Always ensure your input voltage is within this supported voltage range.

To make power connection – Follow the printed polarity for V+, V- and ground. Connect positive wire to V+, connect negative wire to V-, and connect ground/earth to grounding screw as shown. For power redundancy, this unit can be connected to two power inputs.  
+V1 is for power input one connection  
+V2 is for power input two connection

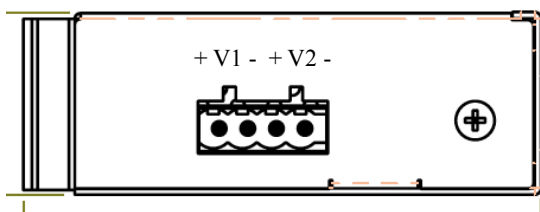

## Connecting procedure

- STEP 1: Connect ground/earth to grounding screw.
- STEP 2: Pull out 4-pin terminal block in the included mounting kit package.
- STEP 3: Connect power wire to V1+, V1-, V2+, and V2- with correct polarity.  
Possibly connect alarm relay.
- STEP4: Plug the connector into terminal block socket shown above.

**WARNING** – Always SHUT OFF power source to connect power wire.

**WARNING** – Any exceeded input voltage will not make this unit function and may damage this unit.

## LED indicator

PW: Power 1, Power 2

Mode A: Green LED ON --  
For End-Span POE power  
1,2,3,6

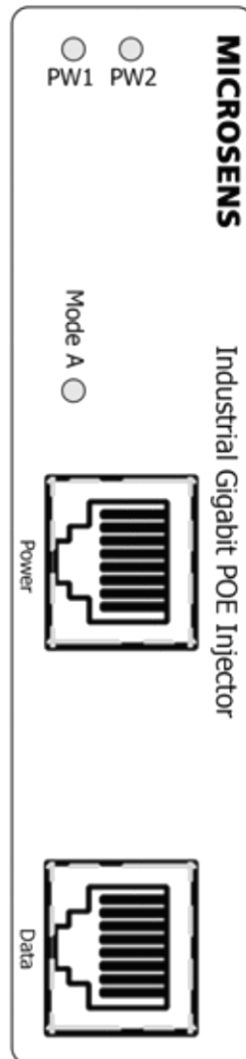

## Specifications

<b>IEEE Standard</b>	IEEE 802.3 10Base-T Ethernet IEEE 802.3u 100Base-TX Fast Ethernet IEEE 802.3ab 1000Base-T Gigabit Ethernet IEEE 802.3af for PoE IEEE 802.3at for PoE+
<b>Network Connector :</b>	1x RJ-45 10/100/1000Base-T Data 1x RJ-45 10/100/1000Base-T PSE with PoE Output power
<b>Network Cable</b>	UTP/STP above Cat.5e Cable EIA/TIA-568 10-ohm (100 m)
<b>Protocol</b>	CSMA/CD
<b>LEDs</b>	PW1(power 1) Green: ON- power good, OFF- power failed PW2(power 2) Green: ON- power good, OFF- power failed Mode A : ON- End Span PD detected
<b>POE Pin Assignment</b>	Default: Mode A (End Span) V+, V+, V-, V- for pin 1, 2, 3, 6
<b>Reverse polarity protection</b>	Present
<b>Overload current protection</b>	Present
<b>Power Supply</b>	2 Redundant power source 44..56 VDC Power Input
<b>Power Consumption</b>	1 W @ 48 VDC full load, without PoE
<b>POE power</b>	Maximum PoE power 36 W at 56 VDC input
<b>Removable Terminal Block</b>	Provide 4 pin terminal block Wire range: 0.34mm <sup>2</sup> to 2.5mm <sup>2</sup> Solid wire (AWG):12-24/14-22 Stranded wire(AWG): 12-24/14-22 Torque:5lb-In/0.5Nm/0.56Nm Wire Strip length: 7-8mm
<b>Operating Temperature</b>	-40°C .. 75°C fully tested
<b>Operating Humidity</b>	5% to 95% (Non-condensing)
<b>Storage Temperature</b>	-40°C .. 85°C
<b>MTBF (Mean Time Between Failure)</b>	510,304 h (MIL-HDBK-217F) at 25°C
<b>Housing</b>	Rugged Metal, IP30 Protection
<b>Case Dimension (L X W X D)</b>	103.5 mm x 32 mm x 81.5 mm
<b>Safety</b>	IEC EN60950-1
<b>EMC/EMS</b>	EN 55022: 2010 +AC: 201 Class A EN 55024: 2010

## Housing Dimensions

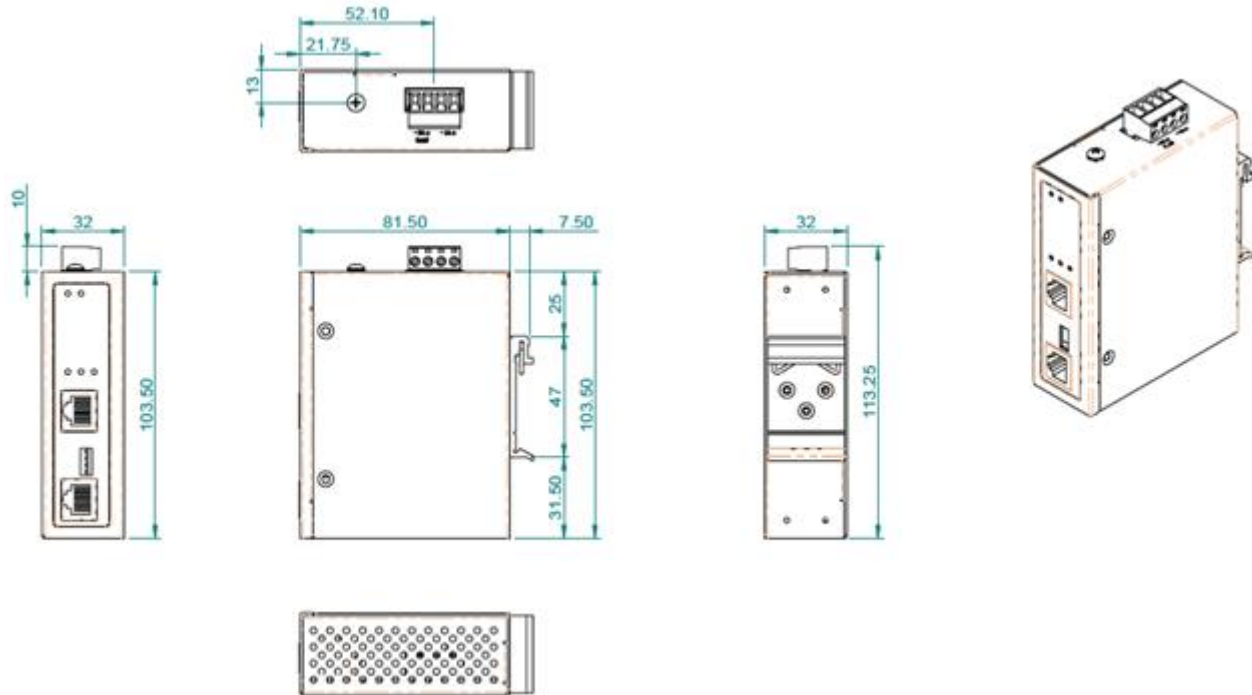

*MICROSENS reserves the right to make any changes without further notice to any product to improve reliability, function or design. MICROSENS does not assume any liability arising out of the application or use of any product. 0617SH*